

如何拆卸螺絲攻 How to take off the tap.

- 1.首先使用4mm六角扳手以逆時針方向進行拆卸。(圖式I)

First, use 4mm hex wrench to loosen the nut by turning it anti-clockwise.
(view I)

(圖式I) (view I)

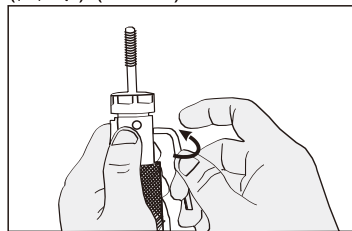

- 2.將輔助圓棒放置於夾頭上方圓孔(圖式J)

To put the auxiliary rod into the hole.
(view J)

(圖式J) (view J)

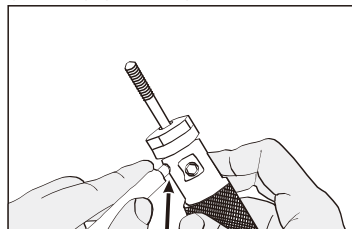

- 3.並使用30mm開口扳手逆時鐘方向拆卸螺帽後即可完成拆卸。(圖式K)(圖式L)

And then use the 30mm open wrench to loosen the 30mm cap nut by turning it anticlockwise. (view K)(view L)

(圖式K) (view K)

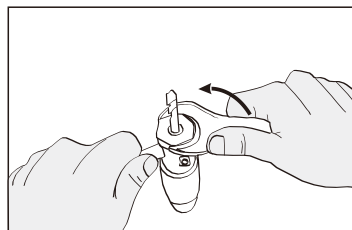

(圖式L) (view L)

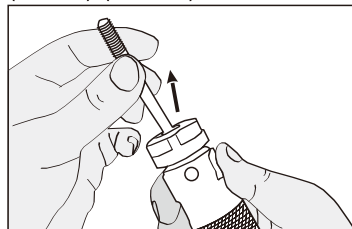

可調式扭力攻牙筒夾 ADJUSTABLE TORQUE TAPPING CHUCK

操作說明書 Instruction Manual



- 如何安裝螺絲攻
How to put the tap on the torque chuck.
- 如何調整螺絲攻尺寸
How to adjust the tapping size.
- 如何拆卸螺絲攻
How to take off the tap.

※ 注意事項

- 使用完後請將扭力調整至低扭力

※ NOTICE

- After using, please turn the torque to the lowest value.

如何安裝螺絲攻 How to put the tap on the torque chuck

1. 將螺絲攻放入筒夾內 (圖式A)

Put the tap on the torque chuck. (view A)

(圖式A) (view A)

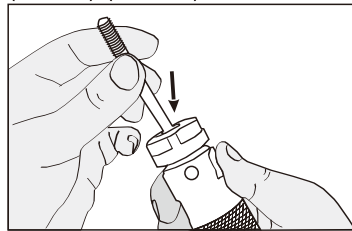

2. 先將筒夾鎖緊 (圖式B)

Tighten the nut by hand. (view B)

(圖式B) (view B)

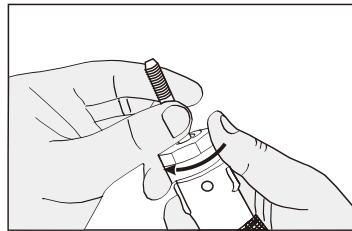

3. 再使用4mm六角扳手順時針方向鎖緊螺帽 (圖式C)

Use the 4mm hex wrench to tighten the nut by turning it clockwise. (view C)

(圖式C) (view C)

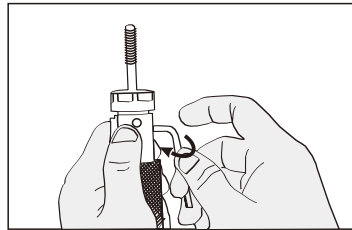

4. 將輔助圓棒放置於夾頭上方圓孔 (圖式D)
(view D)

(圖式D) (view D)

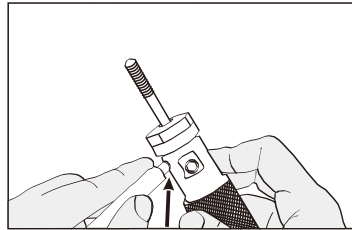

5. 並使用30mm開口扳手順時鐘方向鎖緊螺帽，及完成安裝。(圖式E)

And then to use the 30mm open wrench to turn the nut clockwise until the nut is tightened. (view E)

(圖式E) (view E)

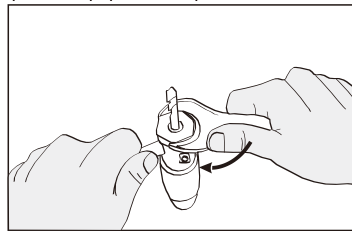

如何調整螺絲攻尺寸 How to adjust the tapping size

1. 將輔助圓棒放置於夾頭上方圓孔 (圖式F)

To put the auxiliary rod into the hole. (view F)

(圖式F) (view F)

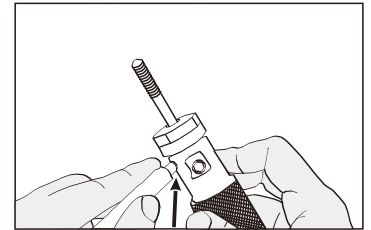

2. 以逆時針旋轉筒夾則其刻度數字越大，反之數字越小。(圖式G)

Turning clockwise to increase the thread size, turning anti-clockwise to decreases the size. (view G)

(圖式G) (view G)

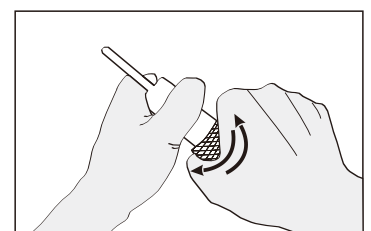

※ 夾頭本體刻度表位置如圖示(圖式H)
其數字表示螺絲攻尺寸，刻度表數字6即為M6

You can see the digit on the surface, the digit refers to the size of the tap. (view H)

(圖式H) (view H)

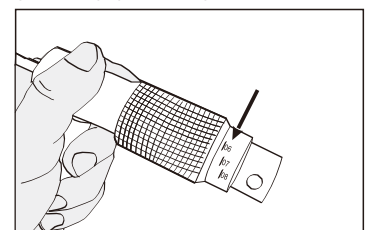

For example: If the digit is 6, it means the tapping size is M6.